

JIS

ANSI/ASTM

DIN/ISO

# ESLON STRAINER

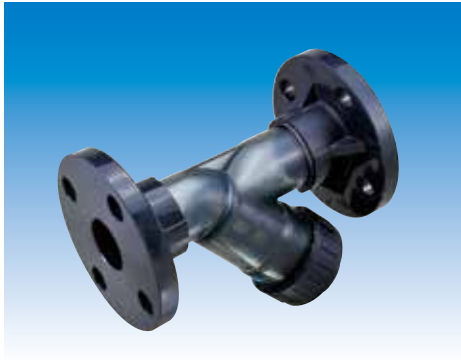

- Transparency body enables easy monitoring medium and screen (15-50A)
- Easy maintenance such as exchange or cleaning up screen by detaching union nut.
- Superior chemical & pressure resistance and durability.

## Flange Type · Thread Type · TS Socket Type and True Union Type

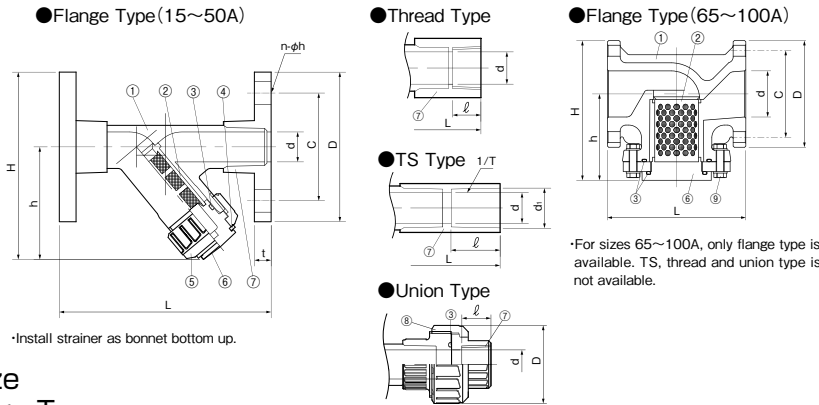

\*Install strainer as bonnet bottom up.

### Parts List

No.	Part Name	Q'ty	Material
①	Body	1	PVC
②	Holder with Screen	1	PVC
③	O-ring	15~50A	EPDM or FKM
		65~100A	
④	Open Ring	1	PVC
⑤	Cap Nut	1	PVC
⑥	Bonnet	1	PVC
⑦	Socket	2	PVC
⑧	Union Nut	2	PVC
⑨	Bolt & Nut	8	SUS304

\*Body in size 65 - 100A is not transparency.

### Size Flange Type

Size		d	L	H	h	Flange (JIS 10K)				Weight (kg/pc)	Q'ty per Carton
A	B					D	C	n-φh	t		
15	1/2	15	150	119	71	95	70	4-15	14	0.4	6
20	3/4	20	158	131	81	100	75	4-15	14	0.5	6
25	1	25	177	157	94	125	90	4-19	14	0.7	6
32	1 1/4	30	197	162	94	135	100	4-19	16	1.0	6
40	1 1/2	40	220	188	118	140	105	4-19	16	1.2	2
50	2	50	264	215	137	155	120	4-19	20	2.0	2
65	2 1/2	65	220	240	153	175	140	4-19	22	3.6	1
80	3	80	240	253	161	185	150	8-19	22	4.4	1
100	4	100	290	283	178	210	175	8-19	24	6.8	1

### Screen Type and Mesh Size

Mesh Size	15A~20A			25A~100A			clear opening	
	PVDC	SUS304	SUS316	PVDC	SUS304	SUS316	PVDC	SUS
10	—	○	—	○	○	—	1.62	2.07
20	—	○	—	○	○	—	0.98	0.93
30	○	○	—	○	○	—	0.54	0.57
40	○	○	—	○	○	—	0.42	0.42
50	○	○	—	○	○	—	0.32	0.33
60	○	○	—	○	○	—	0.26	0.28
70	—	○	—	—	○	—	—	0.24
80	—	○	—	—	○	—	—	0.20
100	—	○	—	—	○	—	—	0.15
120	—	—	○	—	—	○	—	0.13

### Thread Type · TS Socket Type and True Union Type

Size		d	L			H			h	Female Thread		TS Socket			Weight (kg/pc)			Q'ty per Carton
A	B		Thread	TS	Union	Thread	TS	Union		Size	ℓ	d1	1/T Taper	ℓ	PVC			
15	1/2	15	153	190	201	86	86	96	71	Rc 1/2	16	22.4	1/34	30	0.2	0.2	0.3	6
20	3/4	20	176	210	214	99	98	111	81	Rc 3/4	19	26.5	1/34	35	0.2	0.2	0.4	6
25	1	25	200	243	254	117	114	128	94	Rc 1	22	32.6	1/34	40	0.4	0.4	0.6	6
32	1 1/4	32	232	274	287	122	117	135	94	Rc 1 1/4	26	38.6	1/34	44	0.6	0.6	0.8	6
40	1 1/2	40	271	332	301	151	147	167	118	Rc 1 1/2	31	48.7	1/34	55	0.9	0.9	1.3	2
50	2	50	321	390	370	175	172	197	137	Rc 2	38	60.8	1/34	63	1.4	1.4	2.1	2

### Usable Liquid Temperature & Maximum Working Pressure

Material	Size	Usable Temperature (°C)	max. Working Pressure at Room Temp (MPa)
PVC	15A~50A	0~50	1.0
	65A~100A	0~50	0.6

### Conforming Standard

Connection	Standard	Classification
Flange	JIS10K	JIS B 2220
	ANSI	ASME / ANSI B16.5
	DIN/ISO	DIN EN 1092-1 PN-10
Socket	JIS	JIS K 6743
	ASTM	ASTM D2467
Thread	DIN/ISO	DIN8063
	JIS	JIS B 0203 (Rc)
	ANSI	ANSI B1.20.1 (NPT)
	DIN/ISO	DIN2999 (Rc·Rp)

\*For flange, dimension of bolt holes conforming the standards