

JIS ISO\*  
\*Butt spigot only



Operating Temperature(°C)

PVC	0 ~ 50
PP	10 ~ 70
PVDF	-30 ~ 100



## ESLON RELIEF VALVE Type712

### Feature

- De-pressure and prevent from the damage of piping line by excess pressure
- Pressure adjustment range of 0.03 - 1.0 MPa
- Reliable relief performance in both horizontal and vertical direction of pipe line
- Superior corrosion & chemical resistance as all plastic component for contact parts with medium.

### ⚠ Important Notes

- Fluid containing slurry, solid, sediment, or crystallized fluid might disable sealing.

## Maximum Working Pressure - Temperature Rating

Body material : PVC

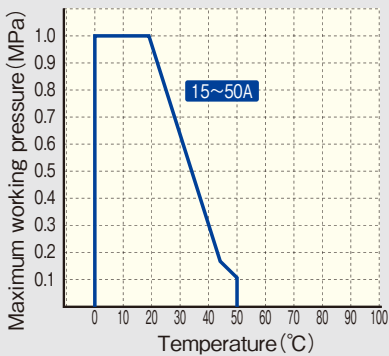

Body material : PP

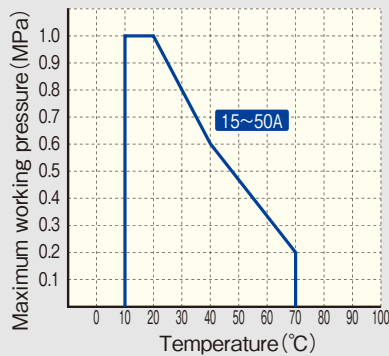

Body material : PVDF

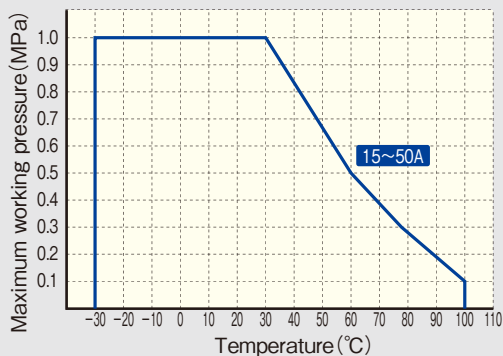
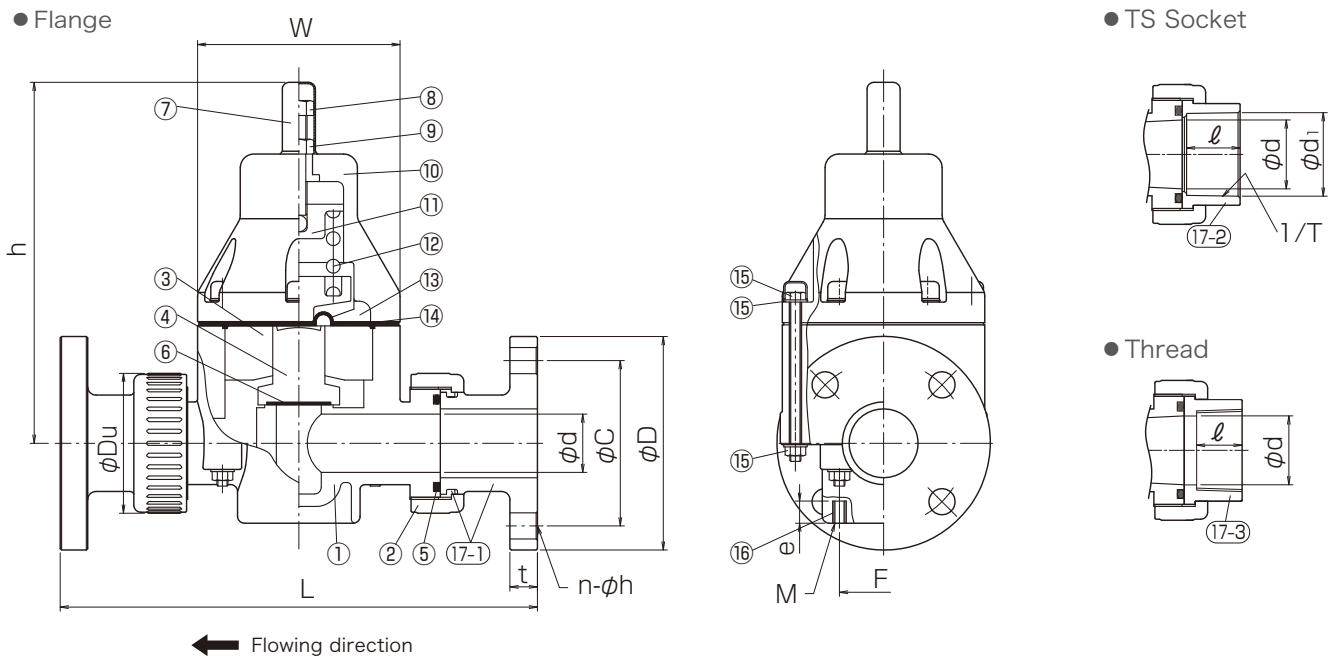

Figure (Flange Type · TS Socket Type · Thread Type)



**Parts List**

No.	Part Name	Q'TY	Material	No.	Part Name	Q'TY	Material
1	Body	1	● PVC ● PP ● PVDF	10	Bonnet	1	GF-PP
2	Union nut	2		11	Pressure plate	1	SS400+Ni plating
3	Separate disc	1	PVC	12	Pressure spring	1	Spring steel
4	Piston	1	PVC	13	Pressure disc	1	SUS304
5	O-ring	2	● EPDM ● FKM	14	Diaphragm	1	PTFE + EPDM
6	Gasket	1		15	Bolt,Nut,Washer	-	SUS304
7	Cover	1	PE	16	Fixing insert nut	1	SUS304
8	Adjust bolt	1	SUS304	17-1	Flange end,Set ring	2	● PVC ● PP ● PVDF
9	Lock nut	1	SUS304	17-2	TS socket	2	● PVC
				17-3	Threaded	2	● PVC ● PVDF

·For PVDF body type, sealing material is FKM.  
·For PVDF body type, butt spigot is available,too. Contact us for more information.

**Size**

**Flange Type**

Unit : mm

Size		d	h	W	Fixing Insert Nut		Flange JIS 10K					Weight(kg/unit)			
A	B				F	Mxe	L	φ D		C	n-φh	t	PVC	PP	PVDF
15	1/2	15	174	81	40	M6×16	224	95	92	70	4-15	14	1.1	1.3	1.3
20	3/4	20	202	107	46	M6×16	255	100	97	75	4-15	14	1.2	1.4	1.4
25	1	26	202	107	46	M6×16	269	125	122	90	4-19	14	2.4	2.8	2.8
32	1 1/4	32	262	147	65	M8×16	323	135	132	100	4-19	16	5.7	6.6	6.6
40	1 1/2	40	262	147	65	M8×16	338	140	137	105	4-19	16	5.9	6.8	6.8
50	2	50	262	147	65	M8×16	346	155	152	120	4-19	20	6.3	7.2	7.2

\*ANSI,DIN:Please contact us

**TS Socket Type · Thread Type**

Unit : mm

Size		d	h	W	Fixing Insert Nut		TS socket JIS				Thread JIS		Weight(kg/unit)		
A	B				F	Mxe	L	φ d1	l / T	ℓ	L	Rc	ℓ	PVC	PVDF
13	3/8	10	172	81	40	M6×16	164	18.3	1 / 31	19	164	Rc3/8	14	0.8	1.0
15	1/2	15	172	81	40	M6×16	117	22.3	1 / 37	22	172	Rc1/2	16	0.9	1.1
20	3/4	21	202	107	46	M6×16	211	26.3	1 / 42	25	209	Rc3/4	20	1.9	2.1
25	1	26	202	107	46	M6×16	220	32.3	1 / 43	29	218	Rc1	24	1.9	2.2
32	1 1/4	33	262	147	65	M8×16	276	38.4	1 / 37	32	276	Rc1·1/4	28	5.0	5.5
40	1 1/2	40	262	147	65	M8×16	281	48.5	1 / 38	35	281	Rc1·1/2	30	5.1	5.6
50	2	50*	262	147	65	M8×16	290	60.6	1 / 34	38	290	Rc2	33	5.2	5.7

\*TS socket:54 \*ASTM,ANSI,DIN:Please contact us

## Pressure characteristic at Inlet Side

The below diagram show the relation of flow rate and pressure increase at inlet. Pressure at inlet increase with increasing flow rate.

