

JIS ANSI/ASME/ASTM DIN



Operating Temperature(°C)

PVC 0 ~ 50



## ESLON CHECK VALVE LIFT TYPE

### Feature

- Reliable checking performance in both horizontal and vertical direction as angle type.
- Easy maintenance by detaching union nut.
- Superior chemical & pressure resistance and durability.

### ⚠ Important Notes

- Valve can be installed both vertically and horizontally. Match the arrow on the valve body to the flow direction when install the valve with bonnet upward.

Horizontal piping

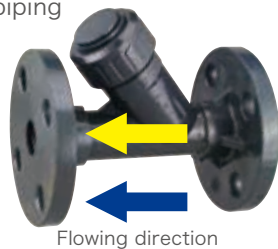

Vertical piping



- Fluid containing slurry, solid, sediment, or crystallized fluid might disable sealing.

### Maximum Working Pressure - Temperature Rating

Body material : PVC

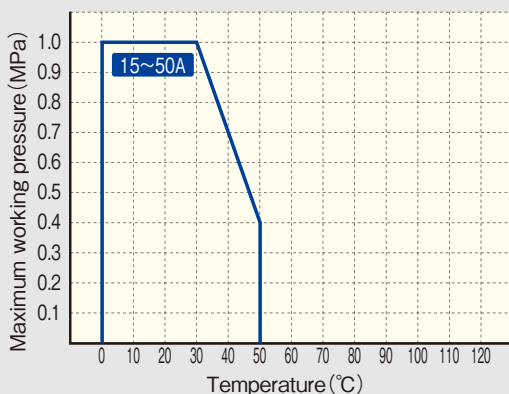
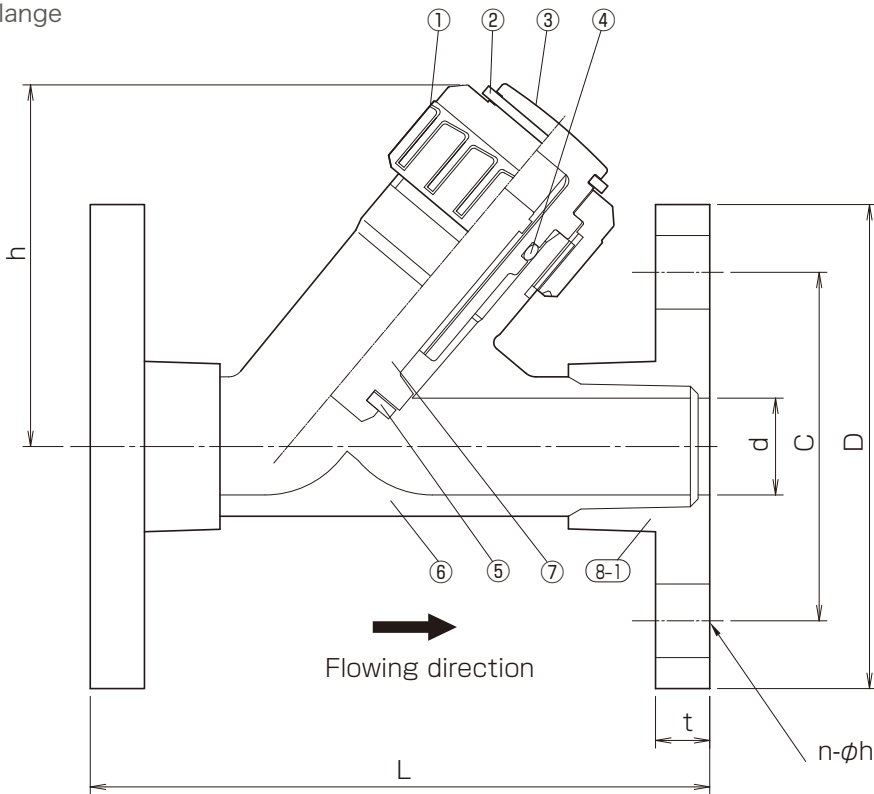
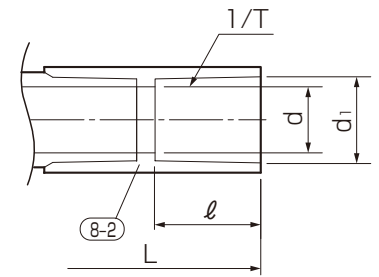

Figure (Flange Type · TS Socket Type · Thread Type)

● Flange



● TS Socket



● Thread

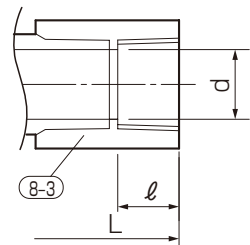

※Install the valve as bonnet upward.

Parts List

No.	Part Name	Q'TY	Material
1	Union Nut	1	PVC
2	Split Ring	1	PVC
3	Bonnet	1	PVC
4	Piston O-ring	1	● EPDM ● FKM
5	O-ring	1	PVC
6	Body	1	PVC
7	Piston	1	PVC+SS
8-1	Flange	2	PVC
8-2	TS socket	2	PVC
8-3	Threaded	2	PVC

Size

Size		d	h	Flange												Weight(kg/unit)		
A	B			L	JIS10K				ANSI				DIN				Flange	TS Socket Thread
		$\phi$ D	$\phi$ C		n- $\phi$ h	t	$\phi$ D	$\phi$ C	n- $\phi$ h	t	$\phi$ D	$\phi$ C	n- $\phi$ h	t				
15	1/2	15	71	130	95	70	4-15	14	89	60.5	4-16	14	95	65	4-14	14	0.4	0.3
20	3/4	20	81	150	100	75	4-15	14	98	69.0	4-16	14	105	75	4-14	14	0.5	0.5
25	1	25	94	160	125	90	4-19	14	108	79.5	4-16	14	115	85	4-16	14	0.8	0.8
32	1 1/4	32	94	180	135	100	4-19	16	117	89.0	4-16	16	140	100	4-18	16	1.0	0.8
40	1 1/2	40	118	200	140	105	4-19	16	127	98.5	4-16	16	150	110	4-18	16	1.4	1.0
50	2	50	137	234	155	120	4-19	20	152	120.5	4-20	20	165	125	4-18	20	2.2	1.2

Size		TS socket					Thread		Union	
A	B	JIS					JIS:Rc		JIS	
		L	$\phi$ d1	1/T	$\ell$	$\phi$ D	L	$\ell$	L	$\ell$
15	1/2	194	22.4	1/34	30	29	146	16	192	22
20	3/4	219	26.5	1/34	35	33	169	19	212	25
25	1	243	32.6	1/34	40	40	192	22	248	29
32	1 1/4	270	38.6	1/34	44	46	230	26	287	32
40	1 1/2	312	48.7	1/37	55	57	250	27	302	35
50	2	363	60.8	1/37	63	70	290	30	364	38

■ Minimum operating pressure(Gasket:EPDM) Unit : kPa

		Size(A)					
		15	20	25	32	40	50
Vertical piping	Min.opened pressure	2.0				3.0	
	Min.closed pressure	50					
Horizontal piping	Min.opened pressure	2.0				3.0	
	Min.closed pressure	50					

※ The pressure in the above table has tolerance.