

JIS10K

ANSI

DIN/ISO

# ESLON BUTTERFLY VALVE FOR UNDER GROUND



- Reliable sealing performance as spherical disc and preventive flange design against over-tightening.
- Worm gear operational from the ground with low torque and wide range of flow rate control.
- Light weight in 1/10 - 1/15 of cast-iron butterfly valve provides easier handling and installation.
- Long spindle type available.

## Parts List

No.	Part Name	Q'ty	Material
①	Body	1	PVC
②	Disc	1	PP
③	Shaft	1	SUS420J2 or SUS316
④	Seat ring	1	EPDM or FKM
⑤	O-ring	2	EPDM or FKM
⑥	O-ring	1	EPDM or FKM
⑦	Cap	1	PP
⑧	Washer	4	SUS304
⑨	Spring Washer	4	SUS304
⑩	Bolt	4	SUS304
⑪	Spasar Ring	—	PVC
⑫	Connector	1	SUS303
⑬	Bolt	—	SUS304
⑭	Worm Gear Box	1	FCD450
⑮	Gasket	1	NBR
⑯	Pin	1	SUS304
⑰	Cap	1	FC200
⑱	Handle	1	ABS

•Quantity of ⑩: 1 for 40~80A, 2 for 100~300A  
 •Quantity of ⑬: 4 for 40~80A, 8 for 100~300A

### ● Cap Type

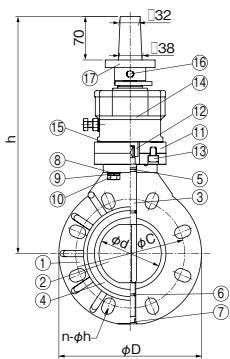

### ● Handle Type

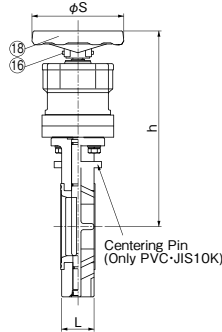

## Size

Size		d	L	h1		D	Flange				S	Weight (kg/pc)		Q'ty per Carton
A	B			Handle	Cap		Water Supply		JIS 10K			Handle	Cap	
							C	n-φh	C	n-φh				
40	1 1/2	45	33	257	318	140	—	—	105	4-19	148	6.1	6.5	1
50	2	57	43	265	326	155	120	4-19	120	4-19	148	6.3	6.7	1
65	2 1/2	71	46	275	336	178	—	—	140	4-19	148	6.5	6.9	1
80	3	80	46	282	343	196	168	4-19	150	8-19	148	6.7	7.1	1
100	4	100	52	320	381	229	195	4-19	175	8-19	148	7.7	8.1	1
125	5	125	56	360	404	254	220	6-19	210	8-23	210	9.7	9.9	1
150	6	150	60	369	413	286	247	6-19	240	8-23	210	10.7	10.9	1
200	8	198	71	421	465	343	299	8-19	290	12-23	210	14.0	14.2	1
250	10	246	73	510	523	410	360	8-23	355	12-25	350	24.8	25.0	1
300	12	299	114	540	553	485	—	—	400	16-25	350	32.5	32.7	1

Unit:mm

## Usable Liquid Temperature & Maximum Working Pressure

Material	Usable Temperature(°C)	max. Working Pressure at Room Temp(MPa)
PVC	0~50	1.0

### ⚠ Important Notes

Fluid containing slurry, solid, sediment, or crystallized fluid might disable sealing.

## Conforming Standard

Connection	Standard	Classification
Flange	JIS10K	JIS B 2220
	ANSI	ASME / ANSI B16.5
	DIN/ISO	DIN EN 1092-1 PN-10

•For flange, dimension of bolt holes conforming the standards