

ESLON  
Plant HT Pipe T-17

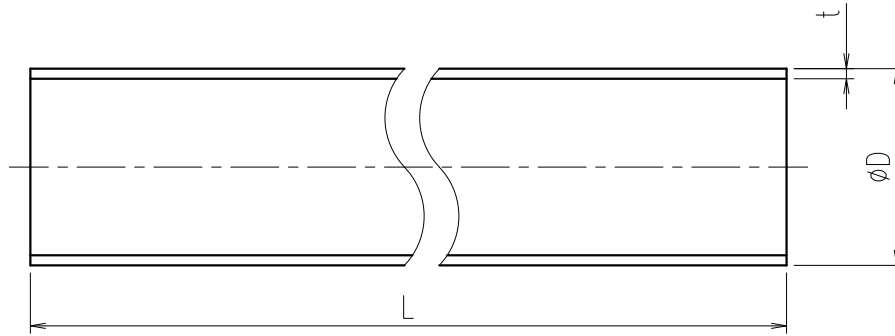

Dimension Table

Unit:mm

Designated Size	Size	φD	t	L	Weight (Ref.) kg/m
□	13	18±0.10	2.5±0.20	4000±10	0.180
□	16	22±0.10	3.0±0.30		0.265
□	20	26±0.10	3.0±0.30		0.321
□	25	32±0.10	3.5±0.30		0.464
□	30	38±0.10	3.5±0.30		0.561
□	40	48±0.10	4.0±0.30		0.818
□	50	60±0.15	4.5±0.40		1.161
□	65	76±0.20	5.0±0.50		1.651
□	75	89±0.25	5.8±0.50		2.244
□	100	114±0.25	7.0±0.60		3.483
□	125	140±0.40	8.2±0.60		5.025
□	150	165±0.45	9.7±0.70		7.004
□	200	216±0.80	11.0 <sup>+1.30</sup> <sub>-0.70</sub>		10.485
□	250	267±1.00	13.6 <sup>+1.50</sup> <sub>-0.90</sub>		16.023
□	300	318±1.10	16.2 <sup>+1.70</sup> <sub>-1.10</sub>		22.732

Note) 1.The tolerance of the outside diameter is the mean outside diameter deviation.

ESLON Plant HT Pipe T-17		DWG No.
		HPI25AT17E
SEKISUI CHEMICAL CO.,LTD.	Date	Approved by:
	2011.02.02	

ESLON  
Plant HT Pipe P-10

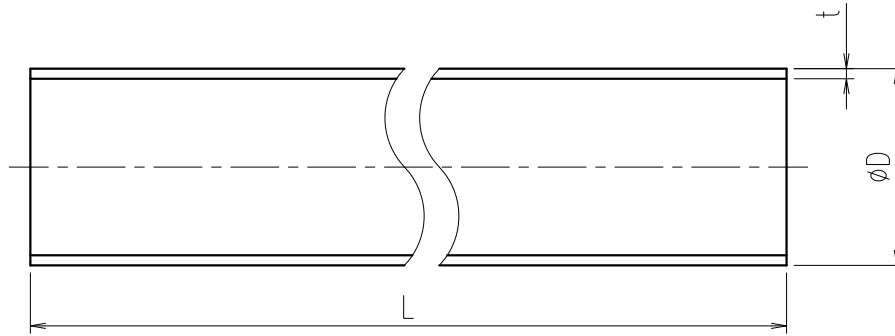

Dimension Table

Unit:mm

Designated Size	Size	$\phi D$	t	L	Weight (Ref.) kg/m
□	16	22±0.10	3.0±0.30	4000±10	0.265
□	20	26±0.10	3.0±0.30		0.321
□	25	32±0.10	3.5±0.30		0.464
□	30	38±0.10	3.5±0.30		0.561
□	40	48±0.10	4.0±0.30		0.818
□	50	60±0.15	4.5±0.40		1.161
□	65	76±0.20	5.0±0.50		1.651
□	75	89±0.25	5.8±0.50		2.244
□	100	114±0.25	7.0±0.60		3.483
□	125	140±0.40	8.2±0.60		5.025
□	150	165±0.45	9.7±0.70		7.004
□	200	216±0.80	11.0 <sup>+1.30</sup> <sub>-0.70</sub>		10.485
□	250	267±1.00	13.6 <sup>-1.50</sup> <sub>-0.90</sub>		16.023
□	300	318±1.10	16.2 <sup>-1.70</sup> <sub>-1.10</sub>		22.732

Note) 1.The tolerance of the outside diameter is the mean outside diameter deviation.

ESLON Plant HT Pipe P-10		DWG No.
		HPI25AP10E
SEKISUI CHEMICAL CO.,LTD.	Date	Approved by:
	2011.02.02	