

Eslon Super Clean Pipe

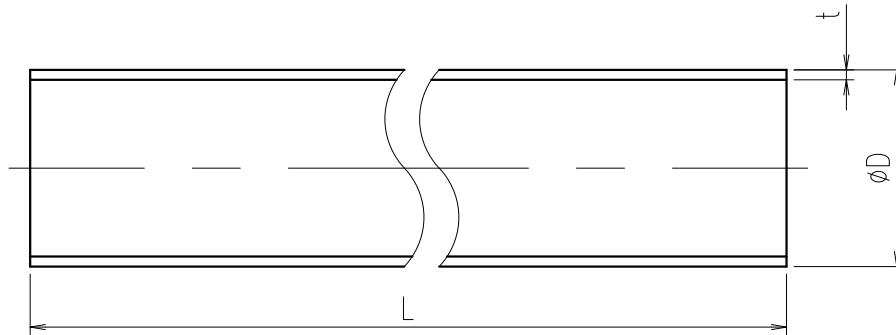

Dimension Table

Unit: mm

Designated Size	Nominal	ϕD	t	L	Weight (Ref.) kg/m
□	13	18±0.20	2.5±0.30	4000±10	0.170
□	16	22±0.20	3.0±0.30		0.251
□	20	26±0.20	3.0±0.30		0.303
□	25	32±0.20	3.5±0.40		0.439
□	30	38±0.10	3.5±0.40		0.531
□	40	48±0.10	4.0±0.40		0.774
□	50	60±0.15	4.5±0.40		1.098
□	65	76±0.20	4.5±0.40		1.415
□	75	89±0.25	5.9±0.40		2.156
□	100	114±0.25	7.1±0.50		3.338
□	125	140±0.35	7.5±0.50		4.371
□	150	165±0.40	9.6±0.70		6.561
□	200	216±0.70	11.0±0.70		9.918
□	250	267±0.90	13.6±0.90		15.157
□	300	318±1.00	16.2±1.10		21.504

Notes) 1. The reference weight is not a part of the standard.

2. The limit deviation tolerance of the outside diameter shows the mean outside

Eslon Super Clean Pipe		DWG No.
		PI133HVE
SEKISUI SEKISUI CHEMICAL CO.,LTD.	Date	Approved by:
	2006.01.12	

HT Eslo Clean Pipe

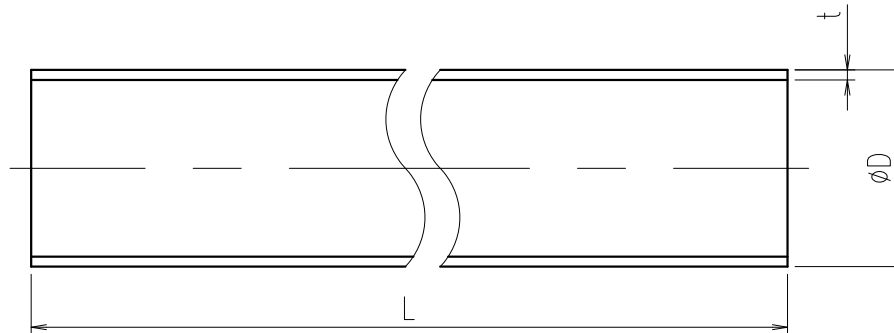

Dimension Table

Unit: mm

Designated Size	Nominal	ϕD	t	L	Weight (Ref.) kg/m
□	16	22±0.20	3.0±0.30	4000±10	0.265
□	20	26±0.20	3.0±0.30		0.321
□	25	32±0.20	3.5±0.30		0.464
□	30	38±0.20	3.5±0.30		0.561
□	40	48±0.20	4.0±0.30		0.818
□	50	60±0.20	4.5±0.40		1.161
□	65	76±0.20	5.0±0.50		1.628
□	75	89±0.25	5.8±0.50		2.213
□	100	114±0.25	7.0±0.60		3.435
□	125	140±0.40	8.2±0.60		4.957
□	150	165±0.45	9.7±0.70		6.910

Notes) The limit deviation tolerance of the outside diameter shows the mean outside

HT Eslo Clean Pipe		DWG No.
		PI133HVE
SEKISUI SEKISUI CHEMICAL CO.,LTD.	Date	Approved by:
	2000.03.28	