

No.	Part Name	Q'TY	Material/Type
1	Body	1	<input type="checkbox"/> PVC <input type="checkbox"/> PP <input type="checkbox"/> PVDF
2	Disc	1	<input type="checkbox"/> PP <input type="checkbox"/> PVDF
3	Shaft	1	<input type="checkbox"/> SUS420J2 <input type="checkbox"/> SUS316
4	Seat Ring	1	<input type="checkbox"/> EPDM
5	O-Ring	2	<input type="checkbox"/> FKM
6	O-Ring	1	
7	Housing Cover	1	GF-PP
8	Housing	1	GF-PP
9	Packing	1	EPDM
10	Washer	4	SUS304
11	Spring washer	4	SUS304
12	Hexagonal bolt	4	SUS304
13	Indicator	1	ABS
14	Shaft Cover	1	PVC
15	Handle	1	ABS
16	Cap	1	PP

Dimension Table

Size	A (B)	φd	L	φD			FLANGE						H1	H2			W1	W2	W3	P	Q	φS	GearBox
				PVC	PP	PVDF	JIS10K		ANSI		DIN			PVC	PP	PVDF							
							φC	n-φh	φC	n-φh	φC	n-φh											
<input type="checkbox"/> 40 (1·1/2)	45	33±1.5	140	138	136	105	4-19	98.5	4-16	110	4-18	72	105	103	102	143	106	90	36	135	125		
<input type="checkbox"/> 50 (2)	57	43±1.5	155	152	150	120	4-19	120.5	4-19	125	4-18	72	112	110	109	143	106	90	36	135	125		
<input type="checkbox"/> 65 (2 1/2)	71	46±1.5	178	174	174	140	4-19	139.5	4-19	145	4-18	72	123	121	119	143	106	90	36	135	125		
<input type="checkbox"/> 80 (3)	80	46±1.5	196	192	190	150	8-19	152.5	4-19	160	8-18	72	130	127	126	143	106	90	36	135	125		
<input type="checkbox"/> 100 (4)	100	52±1.5	229	225	223	175	8-19	190.5	8-19	180	8-18	72	152	149	147	143	106	90	36	135	125		
<input type="checkbox"/> 125 (5)	125	56±1.5	254	249	251	210	8-23	216.0	8-22	210	8-18	84	169	166	164	235	160	124	68	178	210		
<input type="checkbox"/> 150 (6)	150	60±1.5	286	280	278	240	8-23	241.5	8-22	240	8-22	84	178	174	173	235	160	124	68	178	210		
<input type="checkbox"/> 200 (8)	198	71±1.5	343	336	331	290	12-23	298.5	8-22	295	8-22	84	230	225	223	235	160	124	68	178	210		
<input type="checkbox"/> 250 (10)	246	73±1.5	410	402	397	355	12-25	362.0	12-25	350	12-22	115	250	245	243	353	211	180	88	270	350		
<input type="checkbox"/> 300 (12)	299	114±1.5	485	477	474	400	16-25	432.0	12-25	400	12-22	115	280	274	272	353	211	180	88	270	350		

Remarks) Flange dimension is in accordance with the following standard;
(JIS10K) JIS B 2220. (ANSI) ANSI B16.5. (DIN) DIN EN 1092-1 PN10

Client name		Date
Flange Standard	<input type="checkbox"/> JIS10K <input type="checkbox"/> ANSI <input type="checkbox"/> DIN	Approved by:
Rinsed	<input type="checkbox"/> YES	
ESLON BUTTERFLY VALVE PLA-GEAR TYPE SIZE 40 (1·1/2") - 300 (12")		
Drawing No. BFPG403HE		

SEKISUI SEKISUI CHEMICAL CO.,LTD.

350A

400A

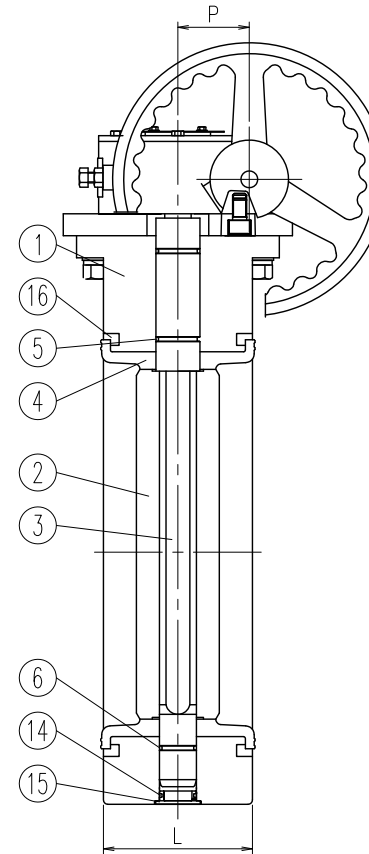
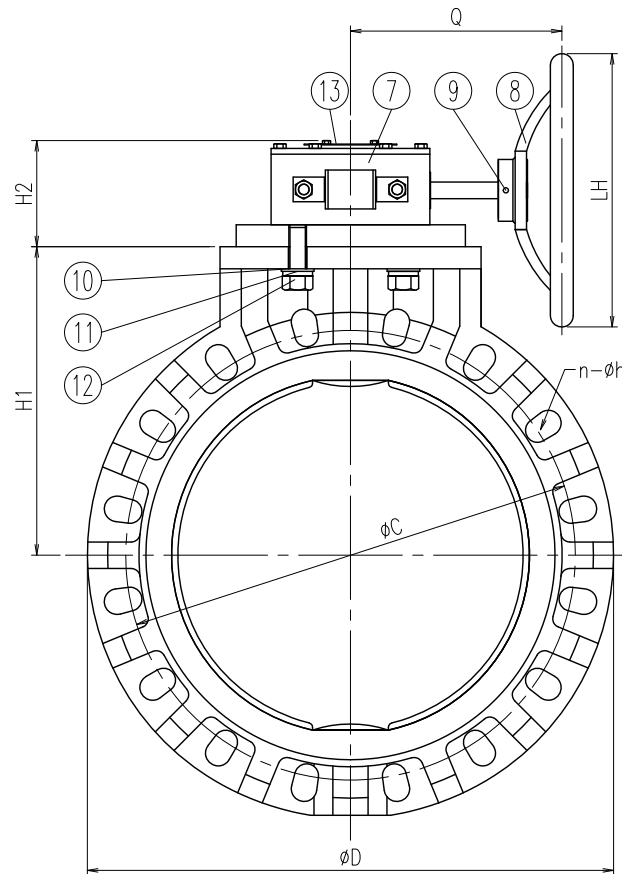

No.	Part Name	QTY	Material/Type
1	Body	1	<input type="checkbox"/> PVC <input type="checkbox"/> PP <input type="checkbox"/> PVDF
2	Disc	1	<input type="checkbox"/> PP <input type="checkbox"/> PVDF
3	Shaft	1	<input type="checkbox"/> SUS420J2 <input type="checkbox"/> SUS316
4	Seat Ring	1	<input type="checkbox"/> EPDM
5	O-Ring	2	<input type="checkbox"/> FKM
6	O-Ring	1	
7	Gear Box	1	-
8	Handle	1	FC
9	Spring Pin	1	SUS304
10	Washer	4	SUS304
11	Spring washer	4	SUS304
12	Hexagonal bolt	4	SUS304
13	Indicator	1	SUS304
14	O-Ring	1	EPDM
15	Cap	1	PP
16	Reinforced Ring (Body:PP)	2	S45C+Painting

Dimension Table

Unit:mm

Size	A (B)	L	ϕD	Flange						H_1	H_2	LH	Q	P
				JIS10K		ANSI		DIN						
				ϕC	$n-\phi h$	ϕC	$n-\phi h$	ϕC	$n-\phi h$					
<input type="checkbox"/>	350 (14)	129	535	445	16-25	476.2	12-29	460	16-22	325	105	310	236	81
<input type="checkbox"/>	400 (16)	169	597	510	16-27	540	16-29	515	16-26	350	130	310	236	81

Note) Bolt hole dimension is in accordance with the following standard;
JIS B 2220 for JIS10K, ANSI B16.5 for ANSI and DIN2501 PN10/PN16 (ISO7005 PN10) for DIN

Client name		Date
Flange Standard	<input type="checkbox"/> JIS10K <input type="checkbox"/> ANSI <input type="checkbox"/> DIN	Approved by:
Rinsed	<input type="checkbox"/> YES	
ESLON BUTTERFLY VALVE GEAR TYPE SIZE 350 (14") - 400 (16")		
Drawing No. BFG3F4HE		
SEKISUI SEKISUI CHEMICAL CO.,LTD.		

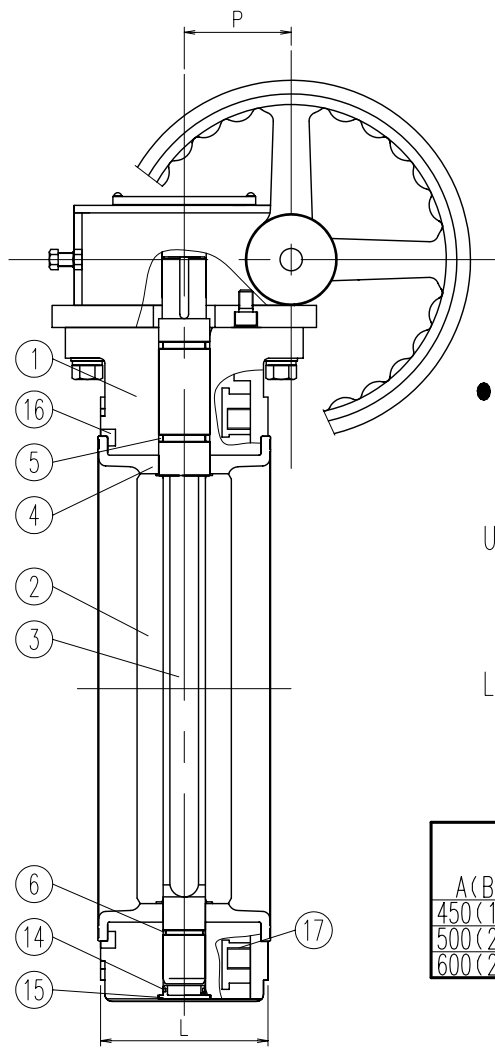
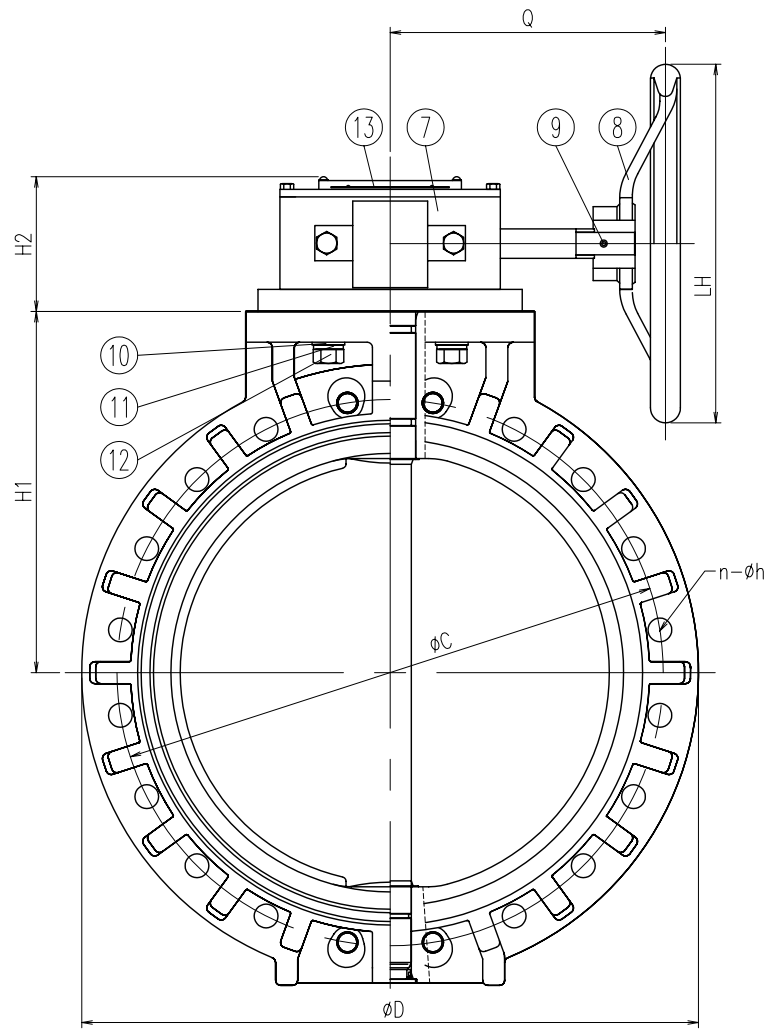

● INSERT DETAIL (450-600A)

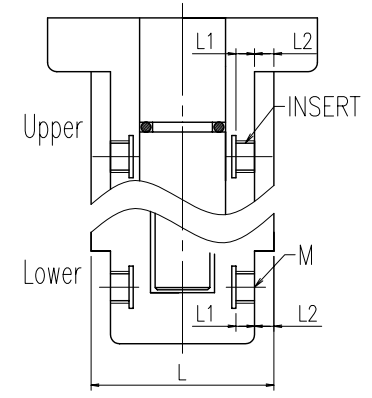

No.	Part Name	Q'TY	Material/Type
1	Body	1	<input type="checkbox"/> PVC <input type="checkbox"/> PP <input type="checkbox"/> PVDF
2	Disc	1	<input type="checkbox"/> PP <input type="checkbox"/> PVDF
3	Shaft	1	<input type="checkbox"/> SUS420J2 <input type="checkbox"/> SUS316
4	Seat Ring	1	<input type="checkbox"/> EPDM
5	O-Ring	2	<input type="checkbox"/> FKM
6	O-Ring	1	
7	Gear Box	1	-
8	Handle	1	FC
9	Spring Pin	1	SUS304
10	Washer	4	SUS304
11	Spring washer	4	SUS304
12	Hexagonal bolt	4	SUS304
13	Indicator	1	SUS304
14	O-Ring	1	EPDM
15	Cap	1	PP
16	Reinforced Ring (Body:PP)	2	S45C+Painting
17	Insert	8	C3604

A (B)	M			Q'TY OF A THROUGH HOLE			Q'TY OF INSERT		L1	L2
	JIS	ANSI	DIN	JIS	ANSI	DIN	UPPER	LOWER		
450 (18)	M24	UNC1-1/8	M24	16	12	16	2x2	2x2	32	20
500 (20)	M24	UNC1-1/8	M24	16	16	16	2x2	2x2	32	20
600 (24)	M30	UNC1-1/4	M27	20	16	16	2x2	2x2	45	18

Dimension Table

Unit:mm

Size	A (B)	L	ØD	Flange									H ₁	H ₂	LH	Q	P
				JIS10K			ANSI			DIN							
				ØC	n-Øh	Insert	ØC	n-Øh	Insert	ØC	n-Øh	Insert					
<input type="checkbox"/>	450 (18)	179	635	565	16-27	4x2-M24	578	12-32	4x2-UNC1-1/8	565	16-26	4x2-M24	370	155	310	236	81
<input type="checkbox"/>	500 (20)	190	700	620	16-27	4x2-M24	635	16-32	4x2-UNC1-1/8	620	16-26	4x2-M24	410	155	407	313	121
<input type="checkbox"/>	600 (24)	209	815	730	20-33	4x2-M30	749	16-35	4x2-UNC1-1/4	725	16-30	4x2-M27	465	155	407	313	121

Note) Bolt hole dimension is in accordance with the following standard;
 JIS B 2220 for JIS10K, ANSI B16.5 for ANSI and DIN2501 PN10/PN16 (ISO7005 PN10) for DIN

Client name		Date
Flange Standard	<input type="checkbox"/> JIS10K <input type="checkbox"/> ANSI <input type="checkbox"/> DIN	Approved by:
Rinsed	<input type="checkbox"/> YES	
ESLON BUTTERFLY VALVE GEAR TYPE SIZE 450 (18") -600 (24")		
Drawing No. BFG4F6HE		
SEKISUI SEKISUI CHEMICAL CO.,LTD.		