

Item Clean Fittings
Socket Dimension 13-150A

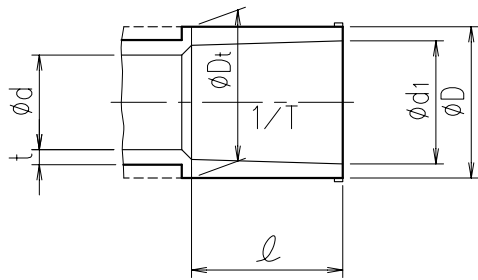

13~50A

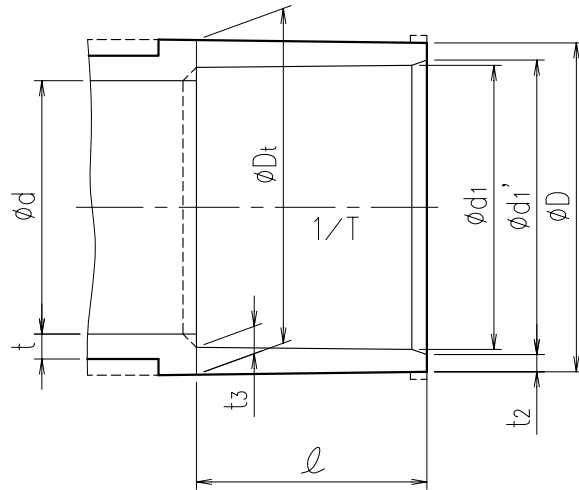

65~150A

Dimension Table

Unit:mm

Designated Size	Nominal Diameter A	ϕD	ϕDt	ϕd	ϕd_1	$\phi d_1'$	t	t ₂	t ₃	1/T	$l^{+4}_{-0.5}$
□	13	24.0 ^{-0.6}	24.0 ^{-0.6}	13	18.40 ^{±0.20}	-	3.0 ^{-0.3}	-	-	1/30	26
□	16	29.0 ^{-0.7}	29.0 ^{-0.7}	16	22.40 ^{±0.20}	-	3.5 ^{-0.3}	-	-	1/34	30
□	20	33.0 ^{-0.8}	33.0 ^{-0.8}	20	26.45 ^{±0.20}	-	3.5 ^{-0.3}	-	-	1/34	35
□	25	40.0 ^{-1.0}	40.0 ^{-1.0}	25	32.55 ^{±0.25}	-	4.0 ^{-0.4}	-	-	1/34	40
□	30	46.0 ^{-1.0}	46.0 ^{-1.0}	31	38.60 ^{±0.25}	-	4.0 ^{-0.4}	-	-	1/34	44
□	40	57.0 ^{-1.2}	57.0 ^{-1.2}	40	48.70 ^{±0.30}	-	4.5 ^{-0.4}	-	-	1/37	55
□	50	70.0 ^{-1.5}	70.0 ^{-1.5}	51	60.80 ^{±0.30}	-	5.0 ^{-0.5}	-	-	1/37	63
□	65	87.0 ^{-1.5}	88.5 ^{-1.5}	67	76.60 ^{±0.30}	76.90	6.6 ^{-0.5}	5.0 ^{-0.5}	6.6 ^{-0.5}	1/48	61
□	75	102.0 ^{-1.5}	104.5 ^{-1.5}	77	89.60 ^{±0.30}	89.90	8.0 ^{-0.5}	6.0 ^{-0.5}	8.0 ^{-0.5}	1/49	64
□	100	130.0 ^{-1.8}	133.5 ^{-1.8}	100	114.70 ^{±0.30}	115.00	10.0 ^{-0.6}	7.5 ^{-0.6}	10.0 ^{-0.6}	1/56	84
□	125	157.0 ^{-1.8}	161.0 ^{-1.8}	125	140.85 ^{±0.35}	141.20	11.0 ^{-0.6}	8.0 ^{-0.6}	11.0 ^{-0.6}	1/58	104
□	150	186.0 ^{-2.0}	190.0 ^{-2.0}	146	166.00 ^{±0.40}	166.40	13.0 ^{-0.8}	10.0 ^{-0.8}	13.0 ^{-0.8}	1/63	132

Item	Clean Fittings Socket Dimension 13-150A	DWG No.
		TU25ATTV(E)
SEKISUI CHEMICAL CO.,LTD.	Date	Approved by:
	2010.06.09	

Eslon Clean Fittings
Socket Dimension 200A~300A

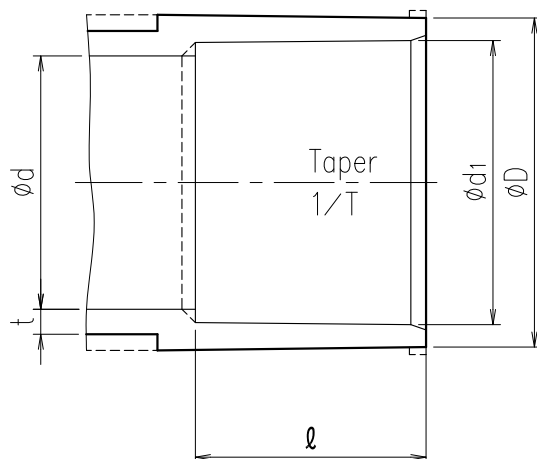

Dimension Table

Unit:mm

Size	A	ϕD	ϕd	$\phi d1$	t	1/T	l
□	200	243.0	196	$217.40^{\pm 0.70}$	13.0^{-0}	1/50	145
□	250	300.0	242	$268.60^{\pm 0.70}$	14.5^{-0}	1/50	175
□	300	356.0	288	$319.80^{\pm 0.80}$	16.0^{-0}	1/50	185

Eslon Clean Fittings
Socket Dimension 200A~300A

SEKISUI

SEKISUI CHEMICAL CO.,LTD.

Date

2007.06.27

DWG No.

TU250TTVE

Approved by: